

Dualit®

O P E R A T I N G
I N S T R U C T I O N S



C O M M E R C I A L



Fig. 1 Blender Assembly

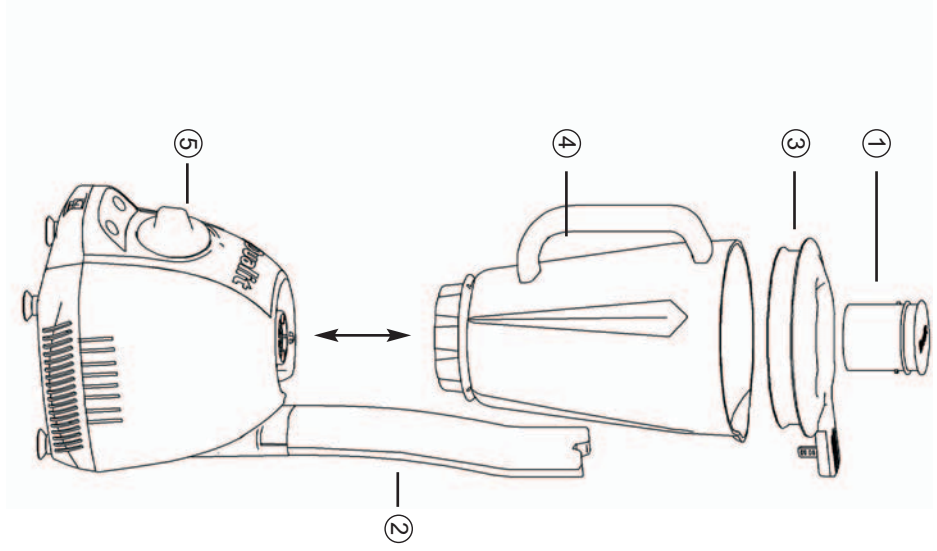
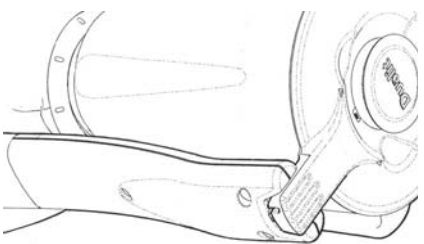
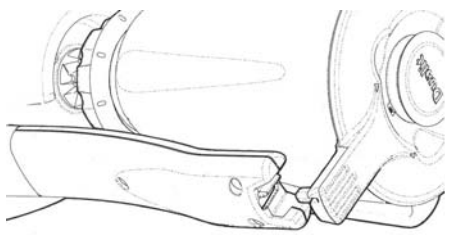

Fig. 2 Safety Interlock System



Closed - Motor will operate



Open - Motor will not run

Fig. 3 Cord Storage

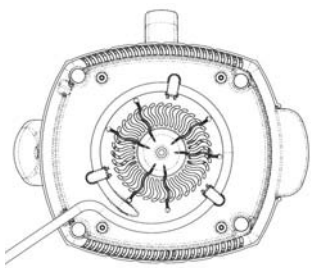
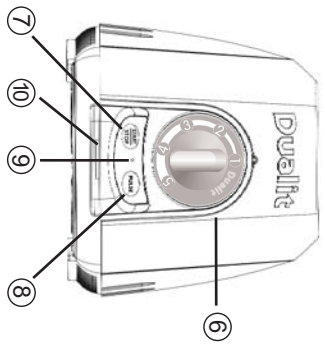

Fig. 4 Control Switches



IMPORTANT SAFEGUARDS

When using electrical appliances, basic safety precautions should always be followed including the following:

READ ALL INSTRUCTIONS

- To protect against risk of electrical shock, do not put blender power base in water or other liquid.
- Close supervision is necessary when any appliance is used by or near children.
- Unplug from outlet when not in use, before putting on or taking off parts, and before cleaning.
- Avoid contact with moving parts.
- Do not operate the blender with a damaged cord or plug or after appliance malfunctions, or is dropped or damaged in any manner. Return appliance to the nearest Authorized Service Centre for examination, repair or electrical or mechanical adjustment.
- Do not use outdoors.
- Do not let cord hang over edge of table or counter.
- Keep hands and utensils out of container while blending to reduce the risk of severe injury to persons or damage to the blender. A scraper may be used but must be used only when the blender is not running.
- Blades are sharp. Handle carefully.
- To reduce the risk of injury never place the cutter assembly blades on base without jug properly attached.
- Always operate blender with Dualit lid in place.
- The use of attachments, not recommended or sold by the manufacturer may cause fire, electric shock or injury.
- When processing hot liquids, use heat proof gloves.
- This is an attended appliance.

- Be certain lid is securely locked in place before operating appliance.
- Never feed food by hand. Always use food pusher.
- Do not attempt to defeat the lid interlock mechanism.
- Any servicing should be performed by an authorized service representative.
- Never turn the blender "ON" for longer than one minute - it may overheat. All foods are fully processed within one minute, especially dry food and small portions.

- Never remove the jug from the power base until motor and blades are stationary. Damage to the clutch can occur.
- Never blend more than 1.4 litres.
- Do not leave the blades in water and never leave the blender jug with any liquid inside it.
- The jug is not a storage container. Keep empty when not in use.

THIS PRODUCT IS INTENDED FOR HOUSEHOLD AND COMMERCIAL USE SAVE THESE INSTRUCTIONS

SAFETY SYSTEM

This appliance is provided with a safety system which disables the mechanism if the jug cover is not (or properly) fitted even if the switch button is "ON".

Note: Do not use the jug to switch the appliance on and off.

- Use this product with rated voltage A.C. outlet only.
- Be sure to unplug the A.C. cord when blender is not being used.

BEFORE PLUGGING IN

- Do not plug the appliance in before checking that the voltage indicated on the rating plate is the same as the electrical supply voltage.
- **UK only.** The wires in the flex are coloured as follows:
Blue = Neutral Brown = Live Green / Yellow = Earth

BLENDER PARTS

- ① Filler cap
- ② Safety Interlock System
- ③ Lid
- ④ Glass jar with blades
- ⑤ Power base
- ⑥ Variable speed control knob
- ⑦ Start/Stop button
- ⑧ Pulse button
- ⑨ Power light
- ⑩ On/Off switch

ELECTRICAL REQUIREMENTS



- UK and Europe 230V, 50Hz a.c. 5 amp
- USA 120V, 50 - 60Hz a.c. 10 amp

SERVICE AND CUSTOMER CARE

If flex is damaged it must, for safety reasons, be replaced by Dualit or an authorised Dualit repairer.

If blender fails to operate refit lid ensuring correct positioning of the plunger into the Safety Interlock System and/or unplug for 15 minutes before replugging.

If problems persist, either contact the shop where you purchased from, or telephone Dualit.

In UK call Dualit Care line 01293 652 500 or email: info@dualit.com

In USA call Dualit Helpline 973 623 9730.

TO ASSEMBLE YOUR BLENDER

- Do not plug in until you have assembled your blender and unplugging straight after use. **Fig. 1**
- Prior to first use, wash lid ③, jug and blade unit ④.
- Place the jug ④ onto the power base ⑤.
- Push the lid ③ onto the jug ④ and at the rear of the lid locate the plunger into the Safety Interlock System ②. **Fig. 2**
- The Dualit blender has a Safety Interlock System that prevents the motor running unless the lid is correctly in position.

SAFETY INTERLOCK SYSTEM

Your blender comes with a unique Safety Interlock System. Only use with the Dualit lid firmly in place on the jug and the plunger correctly positioned into the Safety Interlock System. **Fig. 2**

ALWAYS PLACE ONE HAND ON TOP OF THE LID WHEN THE MOTOR IS RUNNING. ENSURE SAFETY INTERLOCK IS FIRMLY ENGAGED.

USING YOUR BLENDER

- Plug power cord into earthed socket. Blender is now ready for use.
Please Note: The Red 'standby' light indicates that there is power to the Blender. This light changes to a Green light when the blades are running ⑨.
- Place fully assembled jug onto power base.
- Insert foodstuffs into the jug.
- Attach lid, ensuring the safety plunger is in place. **Fig. 2**
Keep hand on rear of lid to ensure safety switch is engaged.
- Switch machine on using ⑩, the red power light ⑨ will illuminate.
- Turn speed control knob ⑥ to desired setting. **Fig. 4**
- Press the start/stop button ⑦, the red light ⑨, will turn to a green light and the blades will rotate.
- To turn off, press the start/stop button ⑦ again.
- To pour, using the handle, lift the jug vertically upwards off the blender base, remove the lid to pour.
- The speed can be adjusted when blending by turning the speed knob ⑥ in either direction.
- All speeds can be used with pulse button ⑧.
- If blending warm foods use an oven glove, place over the lid and only operate on slow speed. **Never place bare hand over the blender lid when blending warm food.**
- On speed control knob **1** is slow **5** is fast.

CORD STORAGE

- To vary the length of the power cord/cable uncoil from storage area beneath powerbase. Fig. 3

PULSE FEATURE

- Ensure the blender is fully assembled and in place on motor base. Place ingredients into the jug and firmly attach the lid.
- Switch blender 'on' ⑩, the red 'standby' ⑨ light will illuminate.
- Press pulse button ⑧, green light ⑨ will glow and blades will rotate at full speed until button ⑧ is released.
- Only use rubber spatula to mix foods when blender lid is removed, the speed knob is at speed **1** and the blades are stationary.

TURBO PULSE

- When blending at any speed the pulse button ⑧ can be pressed for full speed and will hold full speed until pulse button is released and speed will resume to set speed on knob ⑥.

FILLER CAP

- Remove cap ① and add ingredients only at slow speeds.
- When using at high speed, with a full jug or with warm contents, stop blender and then add ingredients.

CLEANING

- Switch off, unplug and disassemble before cleaning.
- Do not let the power base, flex or plug get wet.
- Wipe power base with damp cloth, then dry.
- Do not touch the blades - brush clean under a tap/faucet. Then leave to dry out of children's reach.
- All other parts wash in dishwasher, then dry.
- For your safety the blades are permanently attached to the jar. To clean the jar, quarter fill with warm water, add a few drops of washing liquid and blend for 30 seconds. Repeat if necessary.

GUARANTEE

If your machine goes wrong within one year from the date of purchase, we will repair or replace it free of charge provided:

- You have not misused, neglected or damaged it.
- It has not been modified or you have refitted the plug.
- You supply your receipt to show when you bought it.

This guarantee does not affect your statutory rights.

Dulfit does not assume any responsibility for incidental or consequential damages. Specifications subject to change without notice.

BLENDER TIPS

- Make sure the electrical outlet is rated at the same voltage as that stated on the bottom of the power base.
- Always use the blender on a clean, dry surface.
- Cut most foods into cubes approximately $3/4"$ (1.8cm) to $1"$ (2.5cm) to achieve a more uniform result.
- Use a rubber or plastic spatula as needed, only when the motor is off. Never use metal utensils, as damage may occur to the jug and blades.
- Place lid on firmly. The blender will only operate with the lid correctly positioned on the jug and the plunger inserted in the safety switch.
- Always place one hand on top of the lid when the motor is running.
- Cool hot foods before blending and with all foods, start at slow speed to combine ingredients then increase speed, if necessary. Use heat proof gloves, if blending warm foods.
- For a thicker slusky consistency in frozen drinks, simply add more ice, a cube at a time, until desired consistency is reached.