

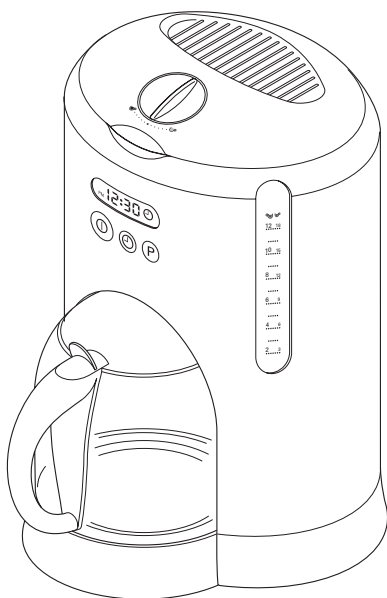

Espressione

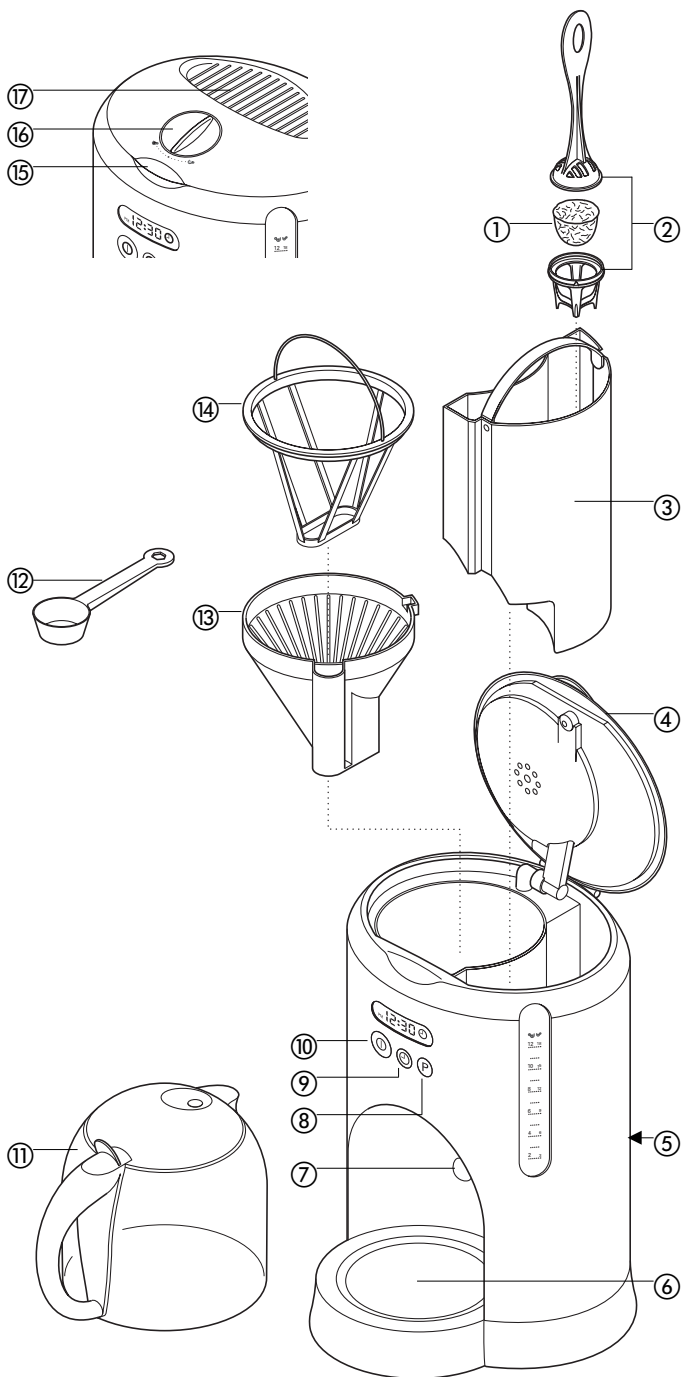

Mod. CM475



IMPORTANT SAFEGUARDS

When using electrical appliances, basic safety precautions should always be followed to reduce the risk of fire, electrical shock and/or personal injury.

1. Read all instructions carefully.
2. Do not touch hot surfaces. Use the handle on the carafe.
3. To protect against electrical shock, do not place cord, plug or coffee maker in water or other liquid.
4. Close supervision is necessary when any appliance is used by or near children.
5. Unplug from outlet when not in use and before cleaning. Allow to cool before putting on or taking off parts, and before cleaning the appliance.
6. Do not operate any appliance with a damaged cord or plug or after the appliance malfunctions or has been damaged in any manner. Return appliance to authorized service facility for examination, repair or adjustment.
7. The use of accessory attachments is not recommended by the manufacturer. It may be dangerous and should be avoided.
8. Do not use outdoors.
9. Do not let cord hang over edge of table or counter, or touch hot surfaces.
10. Do not place on or near hot gas or electric burner, or in heated oven.
11. Always plug cord into the wall outlet before turning on any controls. To disconnect turn power OFF, then remove plug from wall outlet.
12. Always use cold water to make coffee. Warm water or other liquids could cause damage to the coffee maker.
13. Scalding may occur if the cover is lifted or removed during the brewing cycle.
14. Do not use this appliance for other than intended use.
15. Do not set a hot carafe on a wet or cold surface.
16. Do not place hot carafe on or near paper, cloth or other flammable material.
17. Never use the carafe on a range top or in a microwave oven.
18. Do not allow liquid to evaporate from carafe. Do not heat carafe when empty.
19. Do not move entire unit when carafe contains hot liquid.
20. Use the lid on the carafe while brewing and pouring coffee.
21. Discard carafe if damaged in any manner, or a carafe having a loose or weakened handle. A chip or crack could result in breakage or contaminate liquid contents with glass particles.
22. Do not clean carafe with scouring powders, steel wool pads or other abrasive materials.
23. This carafe is designed for use with this coffee maker only.
24. **WARNING:** To reduce the risk of fire or electrical shock, do not remove the bottom cover. No user serviceable parts inside. Repairs should be performed by authorized service personnel only.
CAUTION: Do not immerse in any liquid.
25. **CAUTION:** Do not lift the water tank lid during operation, could cause severe burns. Always lift the lid by the opening lip and when the unit is turned off.
26. Do not touch hot parts, including the cup storage area.

FOR HOUSEHOLD USE ONLY

SAVE THESE INSTRUCTIONS

SHORT CORD INSTRUCTIONS

A short power cord is provided to reduce the risk resulting from entanglement or tripping over a longer cord. Longer detachable power supply cords are available and may be used if care is exercised in their use. If a longer detachable power cord or extension cord is used (1) the marked electrical rating of the extension cord should be at least as great as the electrical rating of the appliance, and (2) the longer cord should be arranged so that it will not drape over the countertop or table top where it can be pulled on by children or tripped over unintentionally. The electrical rating of the appliance is listed on the bottom of the unit. If the appliance is of the grounded type, the extension cord should be a grounded type 3 wire cord. This appliance has a polarized plug. One blade is wider than the other. To reduce the risk of electrical shock this plug will fit in a polarized plug only one way. If the plug does not fit, contact a qualified electrician. Do not attempt to modify the plug in any way.

BEFORE FIRST USE

Place the box on a large, sturdy flat surface. Carefully unpack your coffee maker and remove all packaging material and literature. Remove any labels or stickers from the coffee maker. To remove any dust that may have accumulated during packaging, you may wipe the unit with a clean, damp cloth. Dry thoroughly. Do not immerse the coffee maker in water or other liquid. Clean the carafe, carafe lid, filter basket and filter in warm water with mild detergent.

Rinse and dry thoroughly. Do not use harsh or abrasive cleaners. (See "Cleaning Your Coffee Maker" section of this manual for detailed instructions.) Keep all plastic bags away from children.

NOTE: We recommend that prior to brewing your first pot of coffee, operate the coffee maker once or twice with water only, without ground coffee. This will remove any dust that may have settled inside the coffee maker, which may affect the flavor of the coffee. **IMPORTANT:** Use cold water only. The automatic drip system works best with cold water.

key

- ① water filter
- ② water filter holder
- ③ removable water tank
- ④ lid
- ⑤ compartment for excess cord
- ⑥ hotplate
- ⑦ anti drip activating device
- ⑧ program button
- ⑨ clock button
- ⑩ on/off button with indicator light
- ⑪ glass carafe and lid
- ⑫ measuring spoon
- ⑬ filter holder
- ⑭ permanent coffee filter (or use a paper filter instead)
- ⑮ lid opening lip
- ⑯ aroma control
- ⑰ cup storage area

to make coffee

- 1 Lift the lid.
- 2 Lift out the water tank from the coffee maker.
- 3 Separate the water filter holder by pulling the unit apart and place the water filter inside. Fit the unit back together.
- 4 Turn the handle on the water filter holder and align the arrow on the base with the letter for the current corresponding month eg F for February.
- 5 Lower the water filter holder into the

water tank and fit into position in the recess.

- 6 Fill the tank with the desired amount of water. The water must be between the top and bottom cup marks. Do not fill above the MAX level. (Alternatively fill the water tank when fitted inside the coffee maker but take care not to cause spillage.)
- Use cold water. We recommend using filtered water from a Espressione Water Filter as it reduces limescale. Never use warm or fizzy water.
- 7 Replace the water tank back into the coffee maker.
- 8 Ensure the filter holder is in position in the coffee maker.
- 9 Fit either the permanent filter supplied or a paper filter into the filter holder. Add the coffee, use the spoon provided (approximately 1 level spoon per cup or to taste).
- 10 Close the lid and adjust the aroma control as required. Turn the control to the left for stronger coffee and to the right for weaker coffee.
- 11 Put the carafe on the hotplate.
- 12 Plug into the power supply and press the on/off button.
- 13 Press the on/off button twice to start brewing immediately. The on/off button will glow and the coffee maker will start to operate. The back light of the display will come on and automatically switch off after 10 minutes.
To stop the brewing process at any time, press the on/off button. The back light of the display will come on for one minute and then go off automatically.
- 14 Don't remove the carafe until brewing has finished.
- The hot plate will keep your coffee hot, but the sooner you drink it, the better it will taste.
- Your coffee maker will keep the coffee warm and then automatically switch off after 2 hours. To manually switch off earlier, press the on/off button..
- As soon as all the coffee has brewed, switch off and unplug the machine.
- If you haven't used the machine for a while, run one lot of water through it (without coffee) to clean it out. Fill the water tank to the top cup mark when you do this.

- Never put the carafe in the microwave.

to set the clock

- 1 Plug in the coffee maker, the backlight will come on and the display will flash.
- 2 Select the correct time of day by pressing the clock button once and the time will advance by 1 minute. Press and hold down the button and the time will advance in 15 minute intervals.
- If required, press the program button once to change between the 12 and 24 hour clock.
- 3 To set the clock press the on/off button or wait 1 minute for it to automatically set.
- To re-adjust the clock at any time, press and hold the clock button for 5 seconds and adjust the clock as above.
Note – the backlight of the display will automatically turn off after 1 minute.

to program automatic brew

- 1 Set the clock to the correct time (see 'to set the clock').
- 2 Press the program button, the clock symbol and the display will flash.
- 3 Press the clock button until the desired brewing time is displayed (follow procedure in 'to set the clock').
- 4 Press the on/off button to confirm the automatic time selected. (The display panel and the on/off indicator light will flash).
- 5 Press the program button to return to the current time of day (the on/off button will continue to flash). The brewing cycle will begin once the set time is reached and the on/off button will stop flashing.
- If you want to check the automatic time selected, press the program button.
- To override the automatic brewing operation press the on/off button and the coffee maker will start immediately. Press the button again to switch off.

care & cleaning

- Always switch off, unplug and allow to cool before cleaning.
- Never put the machine in water or let the cord or plug get wet.
- Don't wash parts in the dishwasher.

water filter

- Change and discard the water filter after 70 brewing operations or within a calendar month whichever is sooner.

carafe, lid, permanent filter, filter holder, water filter holder

- Wash, then dry.

body

- Wipe with a damp cloth, then dry. Don't use abrasives - they'll scratch the plastic and metal surfaces.

descaling

With use, the display will indicate when the coffee maker requires descaling. A series of solid lines will gradually appear and when 4 appear in the display and flash , the coffee maker has completed 100 cycles or more and requires descaling (see 'to descale').

important

When descaling always remove the water filter and water filter holder first.

to descale

- 1 Buy a suitable descaler.
- 2 Descal the machine.
- 3 After descaling, run several lots of water through the machine to clean it out. Fill the tank to the top cup mark when you do this.
- 4 Wash the parts.
- 5 To reset the descale counter to zero, press the clock and program button at the same time for 2 seconds.

service and customer care

- If the cord is damaged it must, for safety reasons, be replaced by Espressione or an authorised Espressione repairer.

If you need help with:

- using your machine or
 - servicing, spare parts or repairs
- Contact the shop where you bought your machine.

- Replacement glass carafes for this model may be purchased directly from Espressione.