



Espressione

PT - MANUAL DE INSTRUÇÕES
UK - USER'S MANUAL
ES - MANUAL DE INSTRUCCIONES



FAM 500

Dear customer,

With the new FAM 500 coffee machine you have purchased a quality product. Please read and follow these instructions carefully. By doing so, you and your guests will enjoy your FAM500. Please keep these instructions to hand. If you are not sure about anything or would like to receive more information, please ask your local dealer or us. We are always ready to help.

TABLE OF CONTENTS

Legend, control panel, control and indicator explanations.

| | |
|--|----|
| 1.0 - Safety Instructions | 22 |
| 2.0 - General Comments | 23 |
| 3.0 - Starting up/First use | 24 |
| 4.0 - Making coffee | 25 |
| 5.0 - Making hot water | 26 |
| 6.0 - Making steam | 26 |
| 7.0 - Programming (coffee quantity, cup sizes, water hardness, factory settings) | 27 |
| 8.0 - Adjustment of the grinder | 29 |
| 9.0 - Cleaning and care | 29 |
| 10.0 - Descaling | 33 |
| 11.0 - Faults, causes, trouble-shooting | 35 |
| 12.0 - Service and maintenance work | 36 |
| 13.0 - Useful tips and information about coffee | 36 |
| 14.0 - Technical data | 37 |



Legenda

- 1 - Removable water reservoir with cover
- 2 - Cup storage area
- 3 - Swiveling steam and hot water nozzle with cappuccino nozzle
- 4 - Steam / hot water knob
- 5 - Cup tray
- 6 - Removable drip tray with fill-level indicator
- 7 - Removable waste coffee container
- 8 - Coffee bean container with cover

Painel de Controlo

- 17 - On/Off button
- 17a - On/Off indicator
- 18 - 1-cup selection button
- 18a - 1-cup indicator
- 19 - 2-cup selection button
- 19a - 2-cup indicator
- 20 - Steam selection button
- 20a - Steam indicator
- 21 - Coffee quantity button
- 21a - Indicator for coffee quantity
- 22 - Cup filling level button
- 22a - Cup level indicator
- 23 - Cleaning or descaling program button
- 23a - Cleaning program indicator

- 8a - Filling opening with cover for pre-ground coffee
- 9 - Filling opening with cover for pre-ground coffee
- 10 - Filling opening with cover for pre-ground coffee
- 11 - Service door
- 12 - Removable brewing unit
- 13 - Adjustable dispensing head
- 14 - Control panel
- 15 - Power cord
- 16 - Compartment for power cord.

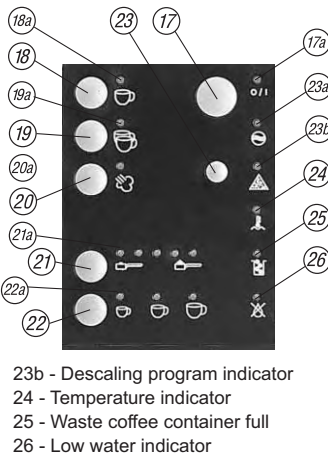

Position of coffee bean container:

- Remove coffee bean container
- Bean (grinder)
- Pre-ground coffee

Explanations for the indicators

- lit – appliance is ready for use;
- flashes – appliance is warming-up or switching-off (integrated rinsing on switching on or off);
- flashes – brewing unit over-filled point 11.0;
- lit – indicates that cleaning is necessary and flashes during the cleaning program in accordance with point 9.4;
- lit – indicates that descaling is necessary and flashes during the descaling program in accordance with point 10.2.;
- flashes – if the temperature is too low (slow flash) or too high (fast flash) and during warming-up after switching on;
- lit – when the operating temperature is reached, the appliance is then ready;
- flashes – waste coffee container is full (the appliance is locked): empty the waste coffee container (appliance must be switched on);
- lit – waste container is missing or not properly inserted
- flashes – when the water container is empty; fill with water and vent in accordance with point 3.5;
- flashes – when the coffee container is set to powder coffee;
- lit – indicates the coffee quantity selected; can be set with button (21);
- lit – indicates the cup level selected; can be set with button (22);
- lit – the corresponding program is running and is blocked for other functions;
- lit – steam; after completion switch off with button (20), and then vent or allow to cool in accordance with point 3.5;

1.0 - Safety Instructions

Please strictly observe the following safety precautions for your own safety and the safety of others. Keep these instructions in a safe place.

DANGER

Electrical power can be fatal! Electrical parts should never come into contact with water: danger of short-circuit! In case of fire, use a carbon dioxide fire extinguisher. Water or powder extinguishers are not suitable.

Children do not understand the dangers associated with electrical appliances. For this reason, children should never be allowed near electrical appliances without supervision. Check the coffeemaker for damage after unpacking. In the likely event that it is damaged, do not use it and contact the repair service.

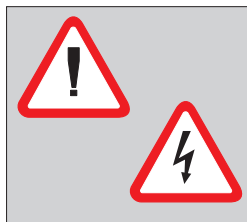

User's manual

The appliance should only be operated after instruction or careful study of the user's manual. Persons who are not familiar with the operating instructions, children and persons under the influence of alcohol, drugs or medication must not operate the appliance or may only operate the appliance under proper supervision.



Power supply

Never use an appliance with a faulty cord. When using an extension cord, this must also be in perfect condition. Place the extension cord in such a position that it is not possible to trip over it. Keep away children and domestic animals. Do not pull on the cord to unplug the appliance and never touch the power cord with wet hands. Do not use in damp or humid rooms (e.g. shower rooms).



Repairs/Maintenance

In the case of a defect, the appliance must only be opened and repaired by an authorized technician. This also applies to damaged cords since special tools are required.

Cleaning

Do not immerse the appliance in water and do not use with wet hands. Always unplug the appliance prior to cleaning. Make sure the power cord does not touch hot parts of the appliance.

The appliance should not be left switched on without supervision.

For safety and energy-saving reasons, it is recommended to switch off the appliance overnight and during absences. After 5 hours the appliance switches off automatically.

Power supply connection

Only connect the appliance to an earthed socket. For your safety, we recommend the use of an earth-leakage safety adapter (available from your electrical store).

The electrical safety of the appliance is only ensured when it is properly earthed in conformity with the standards in force and electrical safety code.

The manufacturer is not liable for any damage arising from the appliance being earthed in a manner not in accordance with regulations. If you are not sure about earthing, please contact a specialist.

If the power socket is not compatible with the plug of your appliance, please have the socket replaced.

Damage can be avoided by never using the appliance without coffee or water. The appliance is only suitable for the making of coffee and coffee specialties as well as for heating water. Inappropriate or inadmissible use of the coffeemaker could result in injury or the user being scalded by hot water or steam.

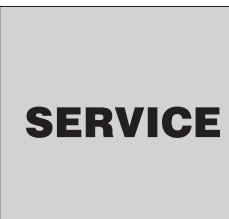

The manufacturer is not liable for damage due to incorrect or inappropriate handling. Pull out the plug before servicing the appliance or cleaning the outside service. Shut down the appliance immediately in case of defects of malfunctioning and undertake no repairs yourself.

Position of the appliance

Place the appliance on a stable, level surface. The surface must not be warm or hot. Choose a position that is out of the reach of children and pets. The distance to walls or other objects must be at least 10 cm.



Do not use the appliance outdoors

Do not expose the appliance to outside weather conditions (rain, snow, frost etc.).



Danger of burns

Be careful when touching the steam nozzle as it becomes hot when in use. Do not direct the steam or hot water jet toward any part of your body: danger of scalding.

Do not put your hands under coffee outlet when coffee is being dispensed.

Above all, make sure when removing the coffee container that no coffee is being brewed.

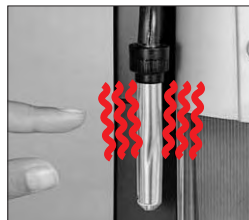

Power supply voltage

On unpacking the appliance, make sure that the power supply voltage of your electrical outlet corresponds to the indication on the rating plate.

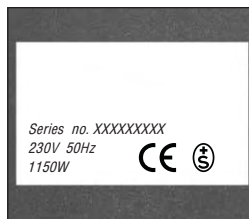

Conditions of use

This espresso machine has been manufactured for household duty only. Do not use the machine for any other purpose. Technical modifications or improper usage are strictly prohibited because of the danger involved.



2.0 - General Comments

Contents: Make sure that you have received all of the following:

- appliance
- cleaning brush
- measuring spoon for powder coffee
- user's manual and guarantee card



Commercial use

This appliance is designed for households and is destined for private use. If it is used commercially, the guarantee conditions change.

Please observe the guarantee conditions carefully.



Packaging

The original packaging is made especially robust to allow transport by post. Please keep the original packing in order to return the appliance if necessary.

Store well away from children.

Cold /Frost

The appliance must be protected against frost, therefore do not leave it overnight in a car in winter, otherwise there is danger of frost damage.

Do not transport the appliance in cold vehicles or keep it in cold rooms. Residual moisture could freeze and damage the coffeemaker.

Non-adherence to the above safety instructions can impair the safety of your appliance.

3.0 - Starting up/First use

Prior to starting the appliance, please observe carefully the safety instructions mentioned under point 1.0.

The appliance should never be used without water or without coffee beans.

3.1 - Unwind the power cord to the desired length (cable compartment in the bottom of the appliance). Connect the appliance to an earthed socket.

Place the appliance on a stable and dry surface.



3.2 - Remove the cover from the coffee bean container and fill the container with fresh coffee beans (approx. 270 g).

Properly close the bean container with the cover. Make sure bean container is aligned with the bean position (I) •.



The grinder is set to the middle position at the factory.

Note: Only pure coffee beans must be used and no types of coffee with a caramelized or aromatic content.

3.3 - Remove the water container towards the front and fill with fresh water (max. 1.5 liters). To fill, either use the filling opening or remove the cover. When replacing, firmly press in the container to make sure that the valve at the back opens.



Caution: Only use fresh, cold water. Use filtered water if in a hard water area. Never use mineral water, milk or any other liquids.



3.4 - Press the main On/Off button. The appliance heats up and carries out an automatic rinse. Both indicators (17a) and (24) flash. As soon as these indicators no longer flash, the appliance is ready for use (Vent the appliance only, point 3.5, if indicator lamp 26 flashes).



3.5 - Venting the appliance

Hold a suitable container underneath the steam and hot water nozzle. Open the steam/hot water knob until a steady stream of water comes out. Close the steam/hot water knob. The machine has now been vented.

Important: The appliance will be automatically vented when making a coffee or using hot water. In case of water shortage while coffee brewing, indicator 26 flashes and indicator 18a or 19a are lit. Refill water tank, press again selection button 18 or 19 and the coffee brewing cycle will continue.



3.6 Ready for use/First coffee

When the indicators (17a) and (24) are lit, press the selector button (18) and the first cup of coffee will be produced.. For reasons of hygiene, we recommend that you do not consume the first cup of coffee.

The appliance is now ready to make coffee!



4.0 Making coffee

It is assumed that the appliance is ready to operate in accordance with point 3.0 'Starting up', i.e. the water container is filled with water, the bean container is filled with coffee beans and the temperature indicator (24) is lit.

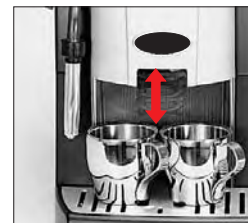

4.1 When the appliance is ready for use, place 1 or 2 cups under the adjustable dispensing head and press the appropriate selection button.

Note: The FAM 500 is equipped with automatic pre-brewing: The ground coffee is first wet, the flow of water is briefly stopped and then the actual brewing operation starts. Prebrewing is only made for small quantities. **Tip:** The dispensing head is height adjustable. For optimum froth production it is recommended to adapt the height of the head to the cups.



4.2 - Setting the cup filling level.

The appliance is pre-programmed at the factory for the 3 products:

-  Espresso
-  Coffee
-  Large cup

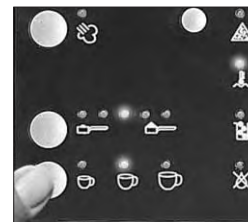

These values can be individually adjusted as described in point 7.2. You have the option to interrupt the flow of coffee at any time by briefly pressing the corresponding selection button. With the selection button (19) the quantity will automatically be doubled.

4.3 - Setting the coffee quantity

The appliance is preprogrammed at the factory. **You have the option to individually adjust the coffee quantity in 5 steps. To adjust quickly, simply press the button until the required quantity is shown and then within 5 seconds press the corresponding coffee selection button (18) or (19).**



After the coffee is delivered the display automatically returns to the factory settings.

Note: You can also reprogram the coffee quantity for the 3 cup sizes in accordance with point 7.1 programming (change the factory settings).

4.4 - Making coffee with pre-ground coffee

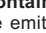
Rotate the coffee bean container to the mark/stop  , the noise emitted by the brewing unit is normal; the coffee quantity indicator (21a) flashes! Open the cover and put in a maximum of 2 level measuring spoons of powered coffee (only use the measuring spoon supplied). Now press the corresponding selection button (18) or (19).

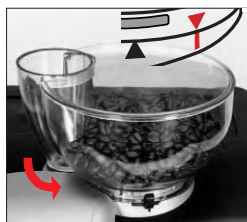

Note: Please put the coffee into the funnel slowly, so that the filling opening does not get blocked. The filling funnel is not a container and the coffee must be used immediately.

Important: Do not use water-soluble, freeze-dried instant coffee or similar products, **only pure ground coffee without additives.** After making pre-ground coffee, return the grinder to the bean position  !



5.0 - Making hot water

For tea, soups etc.

5.1 When the appliance is ready for use, place a glass or cup directly under the steam/hot water nozzle and slowly open the steam/hot water knob. Hot water will be dispensed automatically. To stop the flow of water, close the steam/hot water knob.

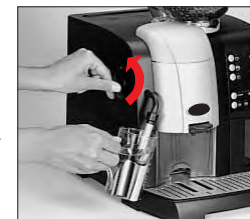

6.0 - Making steam

To heat milk or other beverages and to make cappuccino.

6.1 - When the appliance is ready for use, press the steam selection button (20) Temperature indicator flashes. After approx. 10 seconds or latest when the temperature indicator is lit permanently, open the steam knob and allow the condensed water to flow into the drip tray.

Note: The fast opening of the steam knob will avoid the escape of steam through the dispensing head (normal pressure release).

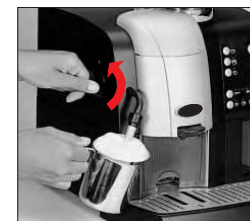

6.2 - Afterwards, immerse the swivel steam nozzle into the liquid to be heated and heat the liquid using a circular movement from bottom to top.

6.3 - If no further steam is required, close the steam knob and move the steam nozzle back to the original position over the drip tray and switch off the steam selection button (20).



Note: It is advisable to clean the steam nozzle of residues with a damp cloth immediately after use. The special frothing nozzle may be removed for cleaning.



Important: The steam nozzle will be extremely hot after the delivery of hot water or steam. Avoid direct skin contact – danger of burns!

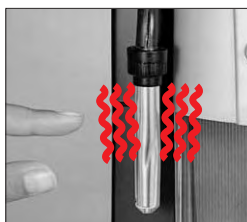

6.4 - With the steam selection button switched off, open the steam/hot water knob again and vent the appliance until a steady stream of water flows from the nozzle and the indicator (24) is again lit.

Then close the steam/hot water knob again. The appliance is now ready to make coffee again.



Important: During the production of steam or when the appliance is over-heated the making of coffee is not possible.

7.0 – Programming

Your FAM 500 is already programmed with the ideal settings at the factory. You have the option to set the appliance to your own individual tastes.

7.1 - Programming the coffee quantity

In addition to the quick setting for the quantity of coffee in accordance with point 4.3, you have the option to individually adjust the factory preprogrammed value for each cup size. Proceed as follows:

a) **First select the corresponding cup size**

☺ or ☹ or ☹ .

b) **Press the coffee quantity button (21) until the required quantity is displayed and keep it depressed until all the LED indicators are lit.** By releasing the button, the new value will be memorized.

c) Repeat the procedure if required for the other cup sizes.



7.2 - Programming the cup sizes

3 cup sizes are preprogrammed at the factory. To change them proceed as follows:

a) Select the cup size ☺ or ☹ or ☹ .

b) **Now press the coffee selection button (18) and keep it depressed until the required quantity of coffee is in the cup. Then release the button (max. 200 ml).** The quantity will be automatically doubled for two cups.

c) Repeat the process if required for the other



Note: To ensure that the change is correctly memorized, it is important to ensure that the selection button is kept depressed during the entire process (from the start of grinding) and is only released at the end.



7.3 - Programming the water hardness

The appliance is pre-programmed for an average value of water hardness of 3, which is the correct setting for normal water conditions. Depending on the water hardness of the available water, the water hardness should be adjusted on the appliance.

Briefly dip the test strips delivered with the appliance into the water (1 second) and gently shake off excess water. The test result can be read off after one minute.

Test strip diagram

- 1 zone red = hardness 1 = value 1 (500 liters)
 2 zones red = hardness 2 = value 2 (300 liters)
 3 zones red = hardness 3 = value 3 (150 liters)
 4 zones red = hardness 4 = value 4 (80 liters)

Depending on the result **the value should be adjusted as follows:**

- Press the cleaning/descaling button (23) and keep it depressed.** Now only the LED indicator for the coffee quantity setting is lit.
- With the cleaning button depressed, you can now change the value in 4 steps with the coffee quantity button (21) where the first LED indicator corresponds to the value 1.** The new value is memorized on releasing the cleaning button.

Note: As soon as the corresponding quantity of water has flowed through the appliance, the descaling indicator is lit and the appliance should now be descaled in accordance with point 10.0 although coffee can still be made.

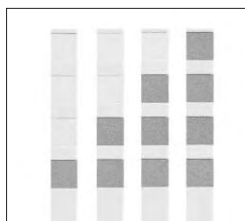

7.4 - Standard programming by the manufacturer

The appliance is programmed by the factory on standard settings which normally ensure perfect results. If you have changed these standard settings with individual programming, you may re-set the appliance to standard settings:

When the appliance is ready for operation, press the cleaning button (23) for at least 10 seconds. The appliance will switch off and when restarting the standard settings are valid.



8.0 - Adjustment of the grinder

The grinder is set at the factory to be suitable for most types of coffee. It should only be adjusted if necessary. With the grinder running adjust the grinding grade with the lever.



Recommended grade: middle position.

Important: The grinding grade must only be adjusted with the grinder running.

Note: If possible, avoid extreme settings. It is preferable to first try another type of coffee (not every type of coffee is suitable).

8.1 Stone protection.

Even premium coffee blends may contain small stones among the coffee beans. To avoid damage, the grinder is equipped with stone protection. **If a stone gets into the grinder, this is heard by a loud clatter. In this case, switch off the appliance immediately.** If no one is present, the grinder turns itself off after some time. Switch the appliance off, unplug the power supply and remove the stone as follows:

a) Remove the coffee beans

b) Rotate the coffee bean container towards the right to the mark/stop  and remove towards the top.

c) Rotate the grinder adjustment lever (8a) counterclockwise to the stop and then remove the grinding ring and the stone. It is best to use a vacuum cleaner to remove the stone and coffee dust from the grinder.

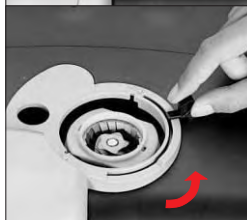

d) Reassemble in the reverse order, i.e. replace the grinding ring, move the grinder adjustment lever to the original position, replace the coffee bean container and move to the normal position.

Important: Do not re-start the appliance prior to removing the stone, otherwise you may damage the motor.

Note: When using very large or oily beans it is occasionally possible that the beans do not easily slide towards the grinder and remain in the container. If this occurs, push the coffee beans towards the grinder intake and **carefully clean the bean container prior to refilling it (the appliance must be switched off!)**.



9.0 - Cleaning and care

Always keep your FAM 500 clean. You will be rewarded by top quality coffee and in addition it extends the working life of your appliance.

9.1 - Daily and weekly cleaning

The housing is best cleaned with a damp cloth and subsequently dried.

Note: Microfiber cloths are ideal for cleaning.

Important: Before cleaning the machine, always switch off and unplug the appliance.



The water container (1), the drip tray (6), the cup tray (5) and the waste coffee container (7) must be cleaned regularly. Use hot water and, if necessary, a non-abrasive cleaning agent. **Do not clean in the dishwasher!**



9.2 - Cleaning the grinder

Normally, the grinder is self-cleaning. It is sufficient to occasionally remove larger coffee residues from the container with the cleaning brush supplied. **Under no circumstances must water be put into the bean container, as this will damage the grinder!**

If a stone or other large residues get into the grinder, proceed in accordance with point 8.1.

9.3 -Cleaning the brewing unit by hand

The brewing unit has to be rinsed at least once or twice a month.

Note: before starting the cleaning program, make sure to remove and clean the brewing unit as well.

Proceed as follows:

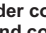
a) Set the coffee bean container to the powder coffee position , the ground coffee quantity indicator (21a) flashes.



b) Open the service door (the coffee dispensing head must be in a position below the door).



c) Press the red retaining lever to the right of the door stop upwards as far as possible.

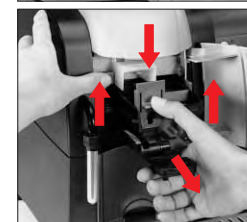

d) Keep the left red security knob depressed and at the same time press down the red interlocking button and remove the brewing unit.



e) Then clean the brewing unit of coffee residues under running water and **also rinse both the chrome filters* as well as possible.**

f) Replace the brewing unit after cleaning and drying it. **Place the brewing unit in the guide way (round metal bar) and check that this also engages in the right guide track. With the red interlock button depressed slide the brewing unit in as far as the stop and only then release the interlock button. (If positioned correctly, this will reengage itself.)**

g) Press the red retaining lever at the right downward to the stop and close the service door.

h) Switch on the appliance, the brewing unit is automatically positioned to the normal position.

i) Put the coffee bean container back to the coffee bean position  (the ground coffee quantity indicator no longer flashes) and after heating up, the appliance is ready for use again.

Tip

With heavy use and to clean both the filters easily, you can move the brewing unit to a special cleaning position with the integrated handle.



- Turn the integrated handle, clockwise, until the end. Both filters are accessible now.

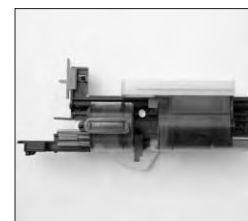
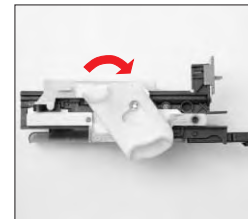

- After cleaning the filters, turn the handle back, counter clockwise, to start position. Replace the brewing unit in the appliance as described under f) and g).

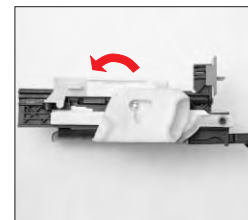

Note: The brewing unit can only be inserted if the handle is positioned as shown in the picture on the right side.

Note: It seems more complicated than it really is. After a short time you will surely have the knack of the procedure and will be rewarded by an appliance that is always hygienically clean. It is recommended to clean the waste coffee container and the inside of the appliance at the same time as the brewing unit.

9.4 - Integrated cleaning program

The FAM 500 features a cleaning program intended as a supplement to the normal daily/weekly cleaning procedure. **It ensures effective removal of coffee fat lodged in inaccessible places**, and together with the removable brewing unit it guarantees great-tasting coffee if used regularly.

Depending on how much the appliance is used, we recommend that you use the program once a month, or at the latest after 250 cups (this is shown by the control indicator 23a). The cleaning program takes approx. 8 minutes.

Note:

Before starting the cleaning program, you must first:

- fill the water container
- empty the waste coffee container (it is used to collect the cleaning water)

The cleaning requires about 1.3 liters of water, including the clean water for rinsing.

- a) Move the coffee bean container to the position powder coffee ☕• (the ground coffee quantity indicator (21a) flashes).



- b) Remove the brewing unit, clean and replace. Close the door and switch on the appliance (in accordance with point 9.3).

- c) Put a cleaning tablet and the small yellow sponge into the powder filling funnel (9).

- d) Pull out the waste coffee container until it is under the coffee dispenser (after emptying). Do not pull out the container too far, please observe the marking.

- e) Press and hold cleaning button (23), press and hold selection button (18) until the program start. The cleaning program now runs automatically. Control indicator (23a) flashes and control indicator (25) is lit during cleaning process. When both of the control indicators (23a and 25) are starting to flash, the cleaning process is done. Empty the waste container and bring it back in place.

- f) Reset the coffee bean container to the coffee bean position ☕• (the ground coffee quantity indicator no longer flashes).

Although the program includes thorough rinsing with clean water, we recommend that you throw away the first cup of coffee before drinking the second.

Note: The program runs through 6 cleaning cycles, including the clean water rinsing cycle, with a pause between each cycle to let the cleaning agent take effect

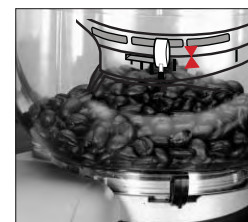

The cleaning program may be started at any time, but at the latest when the control indicator (23a) lights up.

10.0 - Descaling

The FAM 500 features an automatic descaling program that ensures easy and effective descaling.

Depending on the hardness of the water (even if a water filter is used), the appliance must be descaled regularly, at the latest every 4 – 6 months. In areas with especially hard water, descaling will be necessary more often.

The control indicator (23b) reminds you that descaling is necessary. Although you can still make coffee it is advisable to descale without delay.

The water hardness can be adjusted as required in accordance with point 7.3.

10.1 - For descaling use preferably the specially adapted descaling agent Solis Solipol.

Important: Regular descaling protects your appliance from expensive repairs. Damage that is due to insufficient descaling, incorrect operation, and non-compliance with this user's manual is not covered by the guarantee. **Under no circumstances should vinegar be used for descaling, as this will damage the appliance.**



10.2 Descaling with the integrated descaling program

Please observe point 10.0 before running the integrated descaling program.

Note: The descaling program including rinsing takes about 40 minutes and must not be interrupted.

- Move the coffee bean container to the position powder coffee *. The ground coffee quantity indicator (21a) flashes.
- Open the service door, remove the brewing unit, clean and replace. Close the door and switch on the appliance (in accordance with point 9.3).

- Fill the water container with a 1:1 mixture of descaling agent (0.5 liter descaling and 0.5 liter water) and replace the water container in the appliance.

- Pull out the waste coffee container until it is under the coffee dispenser (after emptying). It serves as a collector for the descaling agent. **Do not pull out the container too far, please observe the illustration.**



- e) Press and hold descaling button (23), press and hold selection button (19) at the same time until the programme start. The program now runs automatically. (Control indicator 23a flashes and control indicator 25 is lit)



- f) Place a container under the hot water nozzle and open the hot water/steam knob (4) until the pump switches off and no more water comes out of the nozzle. Close the knob. The descaling now goes automatically via the brewing unit and takes approx. 40 minutes. During descaling the control indicator (23b) flashes.

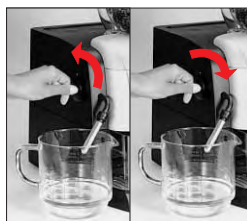

- g) As soon as the control indicator (23b) is lit, empty the waste coffee container, rinse the water container and fill with fresh water. Replace the waste coffee container under the coffee dispenser and replace the water container (see illustration).



- h) Open the hot water/steam knob (4) until the pump switches off and no more water comes out of the nozzle. Close the knob.

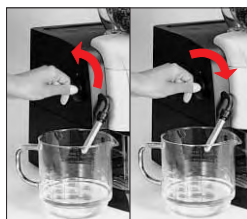

- i) Rinsing with fresh water is now done automatically via the brewing unit. As soon as this is completed, both control indicators (23b and 25) are flashing. And descaling is now complete.

- k) Empty the waste coffee container, and refill the water container with fresh water. The brewing unit goes back to the normal position. The appliance is now ready for making coffee again.

- l) Reset the coffee bean position to the coffee bean position ①• (the ground quantity indicator no longer flashes). The appliance is now ready for making coffee again.



Although the program includes thorough rinsing with clean water, we recommend that you throw away the first cup of coffee before drinking the second.

Note: Descaling can be carried out at any time before the descaling indicator is lit. It is recommended to adjust the appliance to your local water hardness in accordance with point 7.3.

Important: Regular descaling will protect your machine from expensive repairs. Any damage due to a lack of regular descaling, incorrect operation or non-compliance with this user's manual are not covered by the guarantee. **Under no circumstances is vinegar to be used for descaling, as this will damage the appliance.**



11.0 - Faults, causes and trouble-shooting

Repairs may only be carried out by the customer service or by authorized specialists. Incorrect repairs carried out by unauthorized persons may result in substantial danger to the users of the appliance and we decline any responsibility for subsequent damages. In such cases, the guarantee is void.

Prior to returning your machine to the service center for repair, please study the following points carefully. Very often the problem can be solved and inconvenience avoided.

| Fault | Possible causes | Remedy |
|---|---|--|
| On switching on the main switch, the appliance does not come on. | <ul style="list-style-type: none"> - no power supply - service door open | <ul style="list-style-type: none"> - check power cord and fuse - check that the service door is properly closed |
| Coffee is not flowing | <ul style="list-style-type: none"> - funnel for pre-ground coffee is obstructed - no beans or a stone is in the grinder - appliance is adjusted to powder coffee setting - appliance is adjusted to steam setting | <ul style="list-style-type: none"> - remove obstruction - fill with beans or remove stone, see point 8.0 - set the appliance to bean coffee, see point 3.2 - switch off steam and vent the appliance see point 3.5 |
| No hot water/steam | <ul style="list-style-type: none"> - steam nozzle obstructed | <ul style="list-style-type: none"> - clean the steam nozzle and the removable frothing nozzle |
| No crema on the coffee | <ul style="list-style-type: none"> - unsuitable coffee blend - coffee is no longer fresh - cups too cold - coffee is ground too coarsely/too finely | <ul style="list-style-type: none"> - try different coffee blend - refill with fresh beans - preheat the cups - change the grinder setting |
| Brewing unit cannot be removed | <ul style="list-style-type: none"> - brewing unit is not in the normal position | <ul style="list-style-type: none"> - close the service door and switch on the appliance, the brewing unit will now automatically move to the normal position. If necessary, reposition the coffee bean container to the powder position and remove the brewing unit. |
| Heating-up takes longer or water flow is inadequate | <ul style="list-style-type: none"> - the appliance is scaled-up | <ul style="list-style-type: none"> - descale in accordance with point 10.0 |
| The control indicator 23a flashes after coffee grinding cycle | <ul style="list-style-type: none"> - Too high amount of coffee powder in | <ul style="list-style-type: none"> - switch the appliance off and on. The coffee powder will be ejected to the waste container and the appliance is ready for use again. Reduce/adjust the amount of coffee beans for grinding (point 7.1). - funnel for pre-ground coffee overloaded (point 4.4). |

12.0 - Service and maintenance work

For perfect and trouble-free service, the appliance must be cleaned and descaled regularly in accordance with our recommendations. Despite good care every espresso machine is subject to normal wear and tear if used intensively. Regular checks by the an authorized dealer will prolong the life of your machine and ensure top quality coffee.

13.0 - Useful tips and information about coffee

Good coffee depends not only on the appliance used but also on the quality of the water, the blend of coffee, the grinding, the temperature etc.

Please observe the following tips:

- Always use fresh coffee and darker roasts.
- Fresh coffee should always be stored in a cool place in a closed container.
- If the coffee flows out too quickly or to slowly, the reason is usually an incorrect setting of the grinder. Adjust the grinder correspondingly.

Important: Only adjust the grinder when the grinder is running.

- Coffee tastes best when using pre-warmed cups. To warm the cups quickly we recommend rinsing them with hot water from the hot water nozzle.

14.0 - Technical data

Materials used:

Housing ABS plastic

Appliance Data:

Voltage: 230 V (USA: 115V)
Power consumption: 1150 watts
Heating System: thermo-block
Pump: electro-magnetic
Coffee grinder: conical grinder with stone protection
Bean container: approx. 270g
Filling opening for powdered coffee: integrated
Water container: 1,5 litres
Dimensions (WxHxD): 282 x 383 x 398mm
Weight: approx. 9,5kg
Power cord: 1,2 m



EC directives 98/37/EEC, 89/336/EEC and 73/23/EEC in accordance with the EC declaration of conformity.